

اتصال قابل انبساط (Expansion Joint)

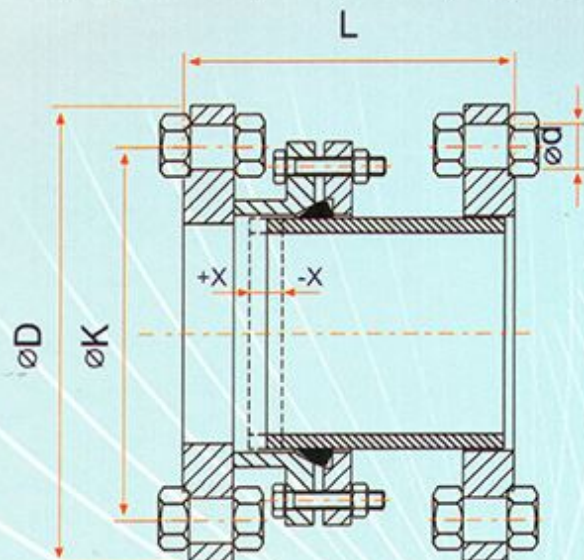

Flange Size, Dimension & Drilling in According to:
DIN2501, EN1092-1, ISO 7005-1

PN 16

DN	D(mm)	K(mm)	L(mm)	X(mm)	NO.of holes	Bolt Size
50	165	125	440	±100	4	2-M12
65	185	145	440	±100	8	2-M12
80	200	160	440	±100	8	4-M12
100	220	180	440	±100	8	4-M12
125	250	210	450	±100	8	4-M12
150	285	240	450	±100	8	4-M12
200	340	295	450	±100	12	6-M12
250	405	355	450	±100	12	6-M12
300	460	410	460	±100	12	6-M12
350	520	470	460	±100	16	8-M12
400	580	525	490	±100	16	8-M12
450	640	585	500	±100	20	10-M12
500	715	650	500	±100	20	10-M12
600	840	770	500	±100	20	10-M12
700	910	840	500	±100	24	12-M12
800	1025	950	510	±100	24	12-M12
900	1125	1050	540	±100	28	14-M16
1000	1255	1170	540	±100	28	14-M16
1200	1485	1390	560	±100	32	14-M16
1400	1685	1590	570	±100	36	18-M16
1600	1930	1820	590	±100	40	20-M16
1800	2130	2020	600	±100	44	22-M16
2000	2345	2230	610	±100	48	24-M16